



# **SC-4 (NSF) SUGARCANE JUICER OPERATOR MANUAL**



**JUICERNET BY MULLIGAN ASSOCIATES, INC.**

2875 Jupiter Park Drive, #1600, Jupiter, FL 33458

Phone: (800) 627-2886 (option 3)

[www.juicernet.com](http://www.juicernet.com)

[service@juicernet.com](mailto:service@juicernet.com)

Revised April 2026

## 1. Introduction

The SC-4 sugarcane juicer is unlike the traditional commercial juicer. It is highly efficient and easy to clean because of the removable rollers and juice cabinet.

### WARNING!

Running sugarcane more than once in the SC4 will cause damage to the bearings, which will shorten the life of your juicer and void warranty.

It is dangerous to get your hand or fingers too close or inside of the intake feed chute. After squeezing juice, be sure to remove and clean all of the juicing parts. Always make sure to turn off the machine and disconnect the power cord before cleaning or troubleshooting.



## 2. Features

- Rollers (17) and juice cabinet (63) are easy to remove for cleaning
- NSF Certified
- Cover of cabinet (34) is brushed stainless steel.
- Stainless steel exterior finish and rollers, easy cleaning, and fine appearance.
- Sugarcane juice and residue automatically divide, getting high efficiency.
- All gear driven, quiet and long life.
- Forward-reverse switch (2L); overload switch (62).
- Safety switch (9), emergency switch (33)

### 3. Main Technical Data

Type/name	SC-4 Sugarcane juicer
Net/gross :	198 / 223 lbs
Power	110, ½ HP 10 amp
Size (w*I*h)	13" x 27" x 21"
Supply	110V/60hz /1/2 hp
Crate dimensions (w*I*h)	16" x 32" x 27"
Efficiency	15 rpm
Sugarcane diameter	Smaller than 2 ¼"

### 4. Operating Steps

- Preparations

- Place the machine on the table/counter after it is taken out of the box. Make sure that no parts are missing. Connect the power plug (4) into a standard 15amp electrical outlet, (make sure the connected outlet is grounded), then turn on the power switch (2) into forward position. Run the machine without load and make sure it sounds smooth and there are no obstructions.

**IMPORTANT: Emergency switch must be in the on position for the juicer to operate**

- For best results cut the sugarcane into shorter pieces, 18-20 inches long, with an angle for easy feeding into the machine. The diameter should be smaller than 2 ¼ inches.
- Check the position of the filter (18) and container to collect juice.
- Before using you must clean the parts. Do not directly spray or soak the outside of the machine with water to avoid damaging the electrical system. It is best to wipe down with a damp cloth. **The juicer is NOT hoseable.**

- Juicing Steps

- Turn on the forward switch (2L) and let the machine run without load for 30 seconds. Then feed the short pieces of sugarcane into the roller. Guide spent peel underneath of the exit chute away from the unit.

## 5. Troubleshooting

<b>Problem</b>	<b>Possible Cause</b>	<b>Troubleshooting</b>
Work lamp (1) is lighted, but machine is not working.	<ol style="list-style-type: none"> <li>1. Cover of cabinet (55) is not in the correct position.</li> <li>2. Safety switch (9A) is wrong.</li> <li>3. Power switch (2) is bad.</li> </ol>	<ol style="list-style-type: none"> <li>1. Insert the cover of cabinet (12) to correct position.</li> <li>2. Change the safety switch (9).</li> <li>3. Change the power switch (2).</li> <li>4. Change the switch (33)</li> <li>5. <b>Check emergency switch and make sure it is on</b></li> </ol>
Work lamp (1) does not light, and machine is not working.	<ol style="list-style-type: none"> <li>1. Check the power to machine is correct.</li> <li>2. Check the circuit breaker to see if it is ok.</li> <li>3. Power switch (62) and power lamp (1A) is bad.</li> </ol>	<ol style="list-style-type: none"> <li>1. Check power cord is plugged in.</li> <li>2. Change the power switch (10A) and power lamp (1A).</li> </ol>
No juice is coming out	<ol style="list-style-type: none"> <li>1. Check the position of the power switch (2).</li> <li>2. Sugarcane is dry.</li> <li>3. Bearing and Seal needs replacing</li> </ol>	<ol style="list-style-type: none"> <li>1. Put the switch in forward position.</li> <li>2. Wash and change the type of sugarcane.</li> <li>3. Change the bearing.</li> </ol>
Broken bits in juice	<ol style="list-style-type: none"> <li>1. The position of the filter (54) is not good.</li> <li>2. Rollers need to be cleaned.</li> </ol>	<ol style="list-style-type: none"> <li>1. Change the filter (54).</li> <li>2. Clean the rollers (17).</li> </ol>
Turbid juice	<ol style="list-style-type: none"> <li>1. Sugarcane is not fresh.</li> <li>2. Sugarcane is not washed.</li> </ol>	<ol style="list-style-type: none"> <li>1. Change the sugarcane</li> <li>2. Wash the sugarcane carefully.</li> </ol>
Little juice	<ol style="list-style-type: none"> <li>1. Bearing is wrong.</li> </ol>	<ol style="list-style-type: none"> <li>1. Change the bearing or gear box.</li> </ol>
Loud Noise	<ol style="list-style-type: none"> <li>1. No oil in the gear box of motor.</li> </ol>	<ol style="list-style-type: none"> <li>1. Add oil or change the motor.</li> </ol>

# Diagram of Main Parts

SC-4 Description of main parts (2024.01.23)  
(Diagram)

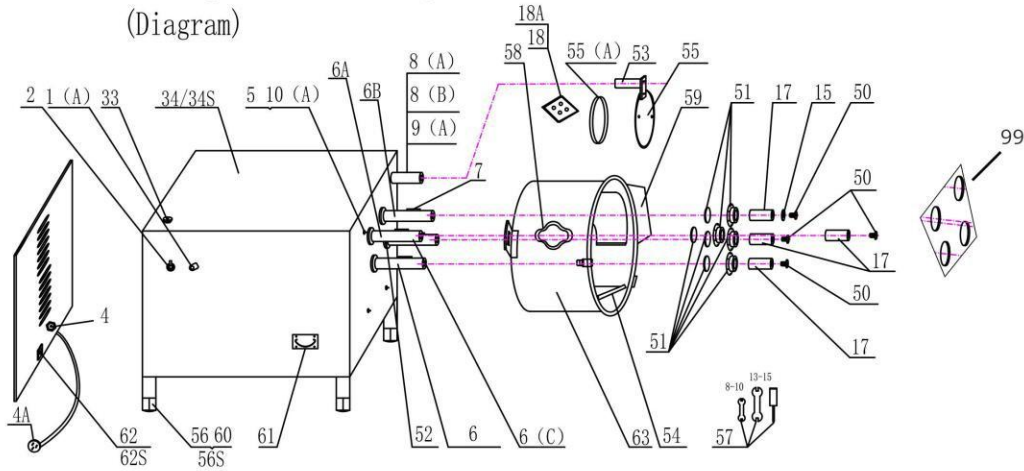

- 34s(L=19.48")
  - 56s(1.96"-3.14")
  - 4(Socket)
  - 4A(power plng cord)
  - 62s(spacer Φ12)
- update  
2022.11.01

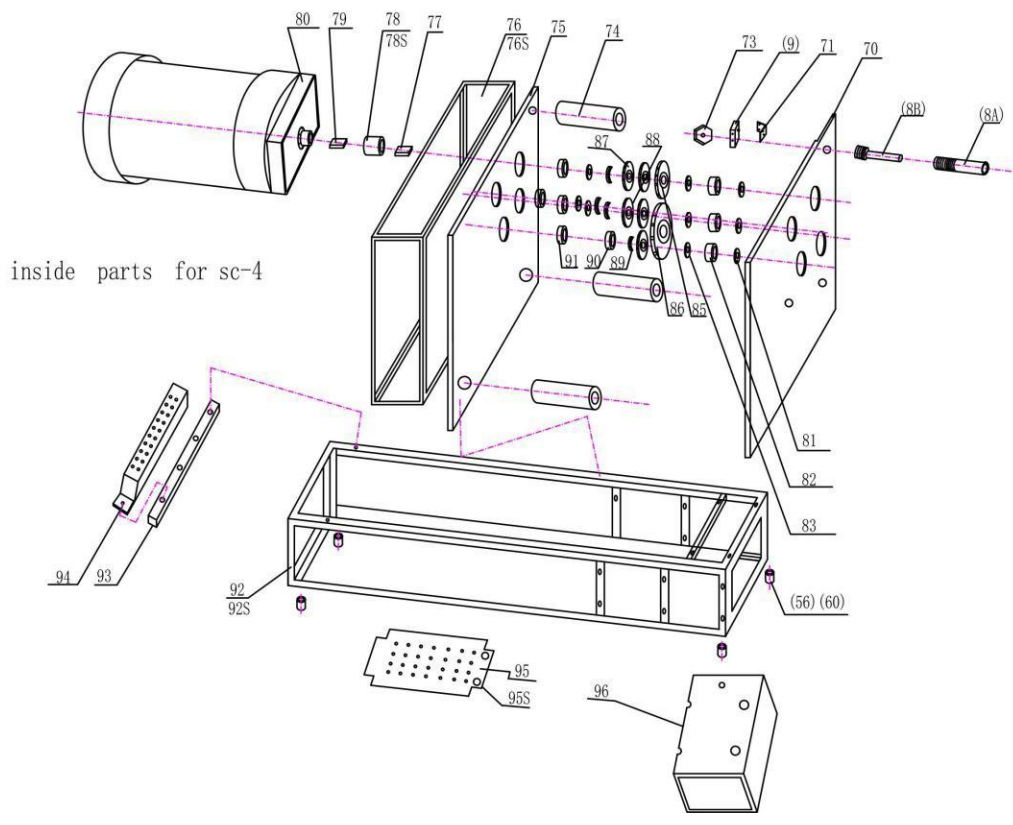

- 76s(B=3.18")
  - 78s(B=2.59")
  - 92s(L=19.09")
  - 95 (fly net)
- update  
2022.11.01

## Description of Main Parts

Part No.	Description	Part No.	Description
SC1 A	Power Light (infix type)	SC50	Roller Screw
SC2 L	Power Switch (On/Off, 25 amp)	SC51	Seal and Cover
SC4	Plug (USA type / 110v)	SC52	Small Nylon Spacer
SC5	Cabin Screw	SC53	Safety Switch Rod
SC4-6 (17)	Lower Roller Shaft (motor right side)	SC54	Filter
SC4-6 A (17)	Upper Roller Shaft (left side)	SC4-55	Lexan Door
S4-6 B (17)	Upper Roller Shaft (right side)	SC4-55 A	Silicone Seal for Cabin
SC4-6C (17)	Lower Roller Shaft (right side)	SC56	Adjust Legs (750-105mm)
SC4-6C	Safety Switch Stick (shorter M5)	SC57	New Tool (8-10#, 14-17# wrenches and straight screwdriver)
SC8 A	Safety Switch Stick (shorter M12)	SC60	100mm Legs
SC9	Safety Switch (110v)	SC62	Circuit Breaker (10 amp)
SC10	Screw (cap nut M6)	SC4-63	Juice Cabin (incl. entry and exit chutes)
SC15	Washer for Roller	SC99	S/S White Plate
SC417	Roller		
SC33	Emergency On/Off Switch (110v)		
SC4 - 34	S/S Body of Machine		