

SC-3 (NSF) SUGARCANE JUICER OPERATOR'S MANUAL



JUICERNET BY MULLIGAN ASSOCIATES, INC.

2875 Jupiter Park Drive #1600, Jupiter, FL 33458

Phone: (800) 627-2886 (option 3)

service@juicernet.com

www.juicernet.com



Revised April 2026

1. Introduction

The SC-3 Sugarcane juicer is unlike any traditional commercial juicer. The SC-3 has removable rollers and juice compartments for easy cleaning. Made with heavy-duty stainless steel, this machine will run at top performance for years to come. The SC-3 is designed with a gearbox which gives the machine more torque, thus reducing the stress on the motor.

This machine is ideal for Juice Bars, Restaurants, Hotels, Supermarkets, Health Clubs, etc.

WARNING!!! It is dangerous to get your hand or fingers too close or inside of the intake feed chute. After squeezing juice, be sure to remove and clean all of the juicing parts. Always make sure to turn off the machine and disconnect the power cord before cleaning or troubleshooting.

2. Features

- NSF Certified
- Roller (17) and juice cabinet (63) is easy to remove for cleaning.
- Cover of cabinet (3) is stainless steel.
- Stainless steel exterior finish and rollers, easy cleaning and fine appearance.
- Sugarcane juice and spent peel automatically divide, getting high efficiency.
- All gear-driven, quiet and long life.
- Forward-reverse switch (2); overload switch (62).
- Safety switch (9), emergency switch (33).

3. Main Technical Data

Type/name	SC-3 Sugarcane Juicer
Net / Gross	198 / 223 lbs.
Power	10 amp
Size (W*L*H)	13" x 27" x 21"
Supply	110V/60hz /1/2 hp
Crate dimensions (W*L*H)	48" x 48" x 30"
Efficiency	15 rpm
Inlet hole diameter	2"

4. Operating Steps

- Preparations
 - Place the machine on the table/counter after it is taken out of the box. Make sure that no parts are missing. Connect the power plug (4) into a standard 15amp electrical outlet, (make sure the connected outlet is grounded), then turn on the power switch (2) into forward position. Run the machine without load and make sure it sounds smooth and there are no obstructions.

Emergency switch must be in the on (up) position for the juicer to operate.

- For best results cut the sugarcane into shorter pieces, 18-20 inches long, with an angle for easy feeding into the machine. The diameter should be smaller than 2 inches.
 - Check the position of the filter (54) and container to collect juice.
 - Before using you must clean the parts. **Do not directly spray or soak the outside of the machine with water, to avoid damaging the electrical system. This will VOID the warranty. It is best to wipe down with a damp cloth. The juicer is NOT hoseable.**
- Juicing Steps
 - Turn on the forward switch (2) and feed the pieces of sugarcane into the feed chute toward the center of the rollers.

5. Diagram of Main Parts

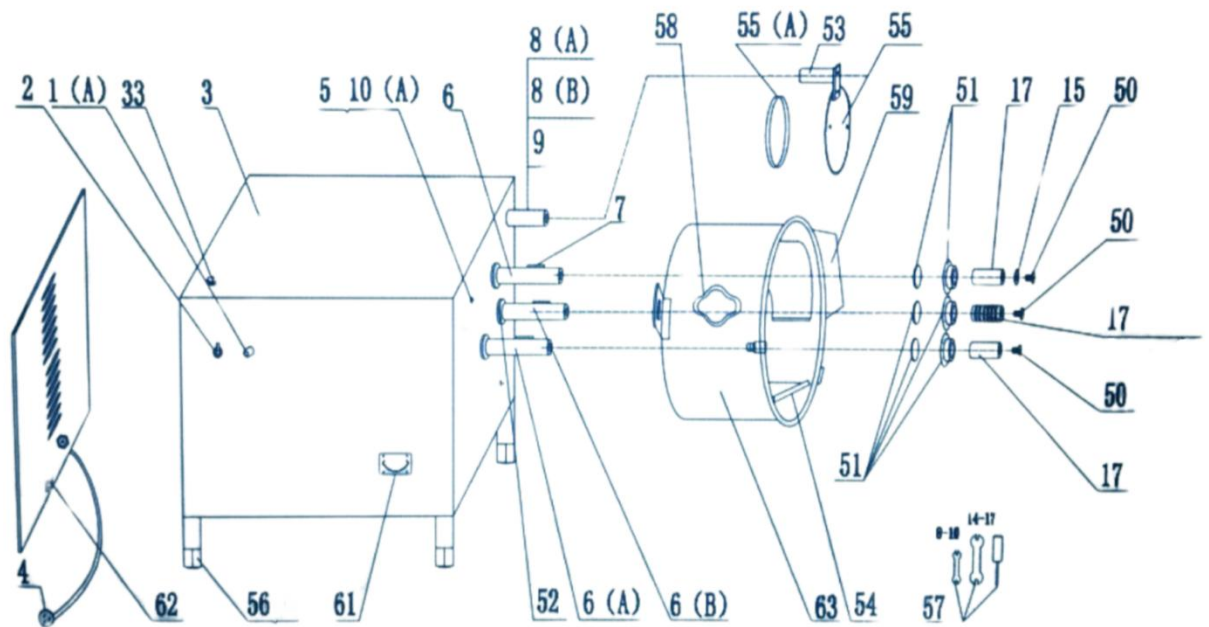

Part No.	Description	Part No.	Description
SC1A	Power Light (infix type)	SC50	Roller Screw
SC2	Power Switch (On/Off, 25 amp)	SC51	Seal and Cover
SC3	S/S Body of Machine	SC52	Small Nylon Spacer
SC4	Plug (USA type / 110v)	SC53	Safety Switch Rod
SC5	Cabin Screw	SC54	Filter
SC6	Roller Shaft (up/motor)	SC55	Lexan Door
SC6 A	Roller Shaft (left side)	SC55A	Silicone Seal for Cabin
SC6 B	Roller Shaft (right side)	SC56	Adjustable Legs (750-105mm)
SC7	Key of Shaft (10x50)	SC57	Tool Kit
SC8 A	Safety Switch Stick (5 ½")	SC61	Handles
SC8 B	Safety Switch Stick (4 ¾")	SC62	Circuit Breaker (10 amp)
SC9	Safety Switch (110v)	SC63	Juice Cabin (incl. entry and exit chutes)
SC10A	Screw (cap nut M6)		
SC15A	Washer for Big Roller		
SC15B	Washer for Small Roller		
SC17	Roller		
SC33	Emergency On/Off Switch (110v)		

6. Troubleshooting

Problem	Possible Cause	Troubleshooting
Work lamp (1) is lighted, but machine is not working.	<ol style="list-style-type: none"> 1. Cover of cabinet (55) is not in the correct position. 2. Safety switch (9) is wrong. 3. Power switch (2) is bad. 	<ol style="list-style-type: none"> 1. Insert the cover of cabinet (12) to correct position. 2. Change the safety switch (9). 3. Change the power switch (2). 4. Change the switch (33) <p>5. Check emergency switch and make sure it is on (up)</p>
Work lamp (1) does not light, and machine is not working.	<ol style="list-style-type: none"> 1. Check the power to machine is correct. 2. Check the circuit breaker to see if it is ok. 3. Power switch (62) and power lamp (1A) is bad. 	<ol style="list-style-type: none"> 1. Check power cord is plugged in. 2. Change the power switch (10A) and power lamp (1A).
No juice is coming out	<ol style="list-style-type: none"> 1. Check the position of the power switch (2). 2. Sugarcane is dry. 3. Bearing and Seal needs replacing 	<ol style="list-style-type: none"> 1. Put the switch in forward position. 2. Wash and change the type of sugarcane. 3. Change the bearing.
Broken bits in juice	<p>The position of the filter (54) is not good.</p> <p>Roller needs to be cleaned.</p>	<ol style="list-style-type: none"> 1. Change the filter (54). 2. Clean the roller (17).
Turbid juice	<ol style="list-style-type: none"> 1. Sugarcane is not fresh. 2. Sugarcane is not washed. 	<ol style="list-style-type: none"> 1. Change the sugarcane 2. Wash the sugarcane carefully.
Little juice	<ol style="list-style-type: none"> 1. Bearing is wrong. 	<ol style="list-style-type: none"> 1. Change the bearing or gear box.
Loud noise	<ol style="list-style-type: none"> 1. No oil in the gear box of motor. 	<ol style="list-style-type: none"> 1. Add oil or change the motor.